

Electromagnetic clutch with bearing

G-Type

Construction and mode of operation

Due to the containing bearing, the stator body does not have to be centred on the input drive.
For further installation advises and technical details, please refer to page 28.

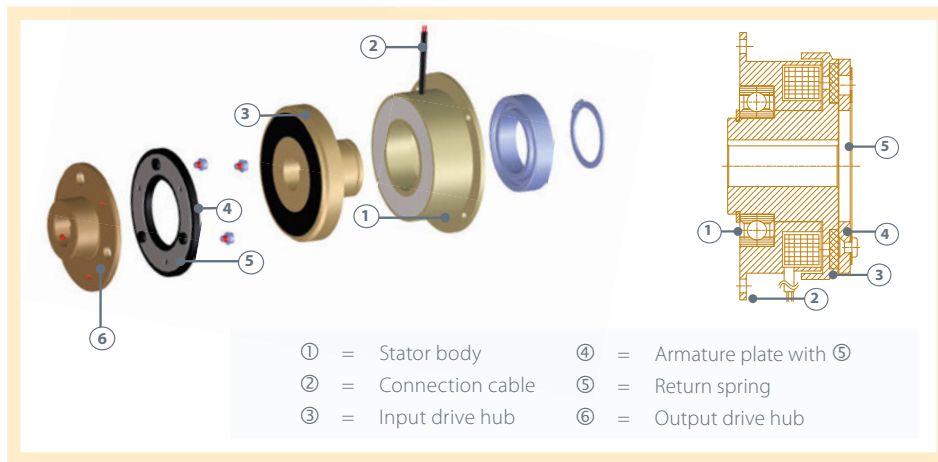

Model A

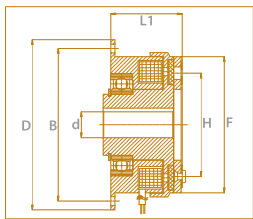

Clutch with input drive hub

Basic version without output drive hub. Connection to output side by screws.

Model C

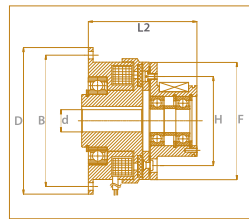

Clutch with input and output drive hub

Basic version with axial output drive (mounted on one shaft). Output drive hub with bearings.

Model D

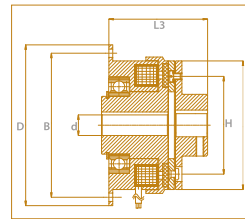

Clutch with input & output drive hub

Basic version with axial output drive (shaft - shaft).

Performance data and dimensions

Size	G03	G04	G05	G06	G07	G08	G09
Torque [Nm] For reference purposes ¹⁾	4.5	8.0	20.0	38.0	80.0	150.0	280.0
Speed of rotation max. [rpm]	8.000	6.000	5.000	4.000	3.000	3.000	2.000
Power [W] T = 20° C	12	20	23	32	40	55	72
d max. [mm] ²⁾	20	25	30	40	50	70	80
D [mm]	80	100	125	150	190	230	290
L1 [mm]	41.0	45.0	52.0	56.5	67.0	75.4	90.0
L2 [mm]	68.0	72.5	92.0	102.5	112.0	130.5	153.0
L3 [mm]	56.0	65.0	77.0	86.5	105.0	123.4	145.0
B [mm]	72	90	112	137	175	215	270
F [mm]	63	80	100	125	160	200	250
H [mm]	46	60	76	95	120	158	210

¹⁾ Depending on design of installation, operating and ambient conditions

²⁾ Keyway to DIN 6885/1